

✓ YOUR GRILL IS READY!

PLEASE READ THE SAFETY INFORMATION AND OPERATING INSTRUCTIONS IN YOUR MANUAL BEFORE INITIAL START UP



HAVE QUESTIONS?

The new grill owners guide is your one-stop-shop for everything from initial fire-up to general operating tips and troubleshooting. For support questions feel free to check out our support page.



NEW GRILL OWNERS
greenmountaingrills.com/new-grill-owners/



GMG SUPPORT
greenmountaingrills.com/support/



TREK

PRIME

ASSEMBLY GUIDE

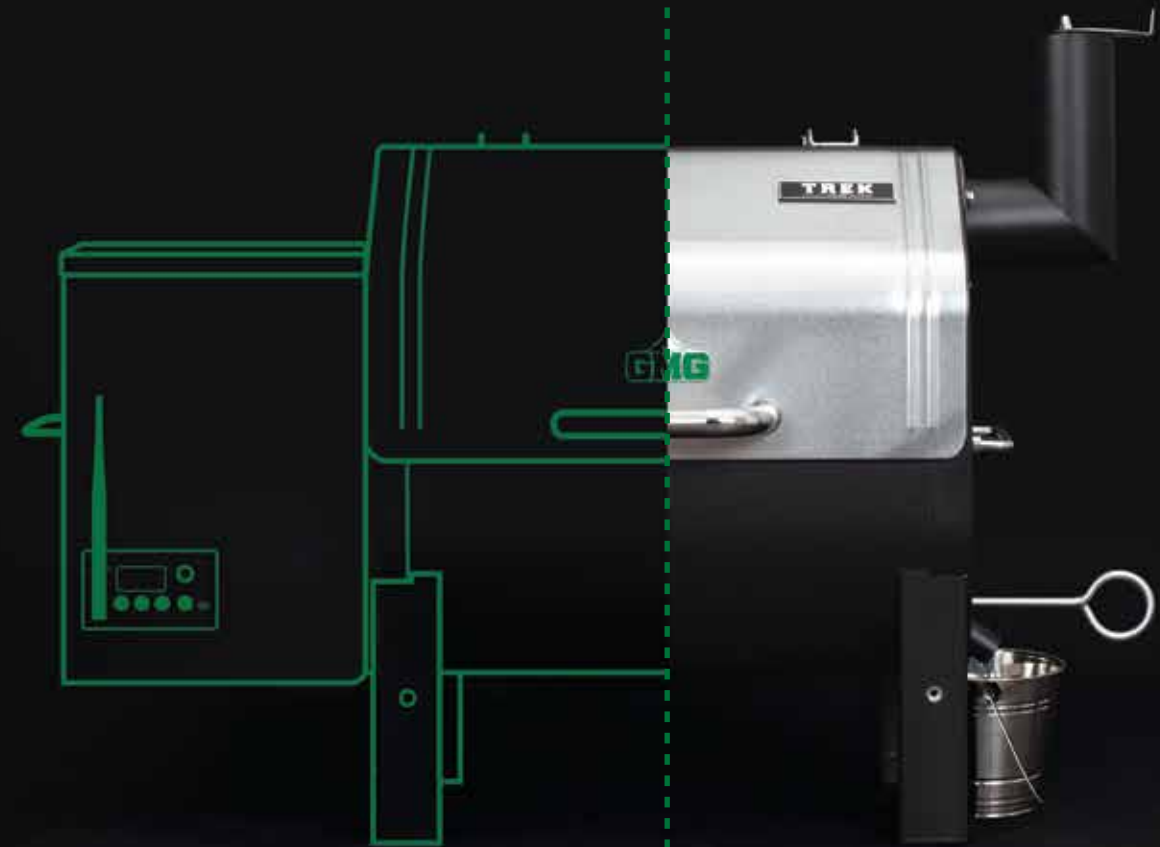

EASY STEP-BY-STEP VIDEO ASSEMBLY

SCAN THE QR CODE WITH YOUR PHONE OR GO TO:
[GREENMOUNTAINGRILLS.COM/GRILL-ASSEMBLY](https://greenmountaingrills.com/grill-assembly)



PLEASE READ AND FOLLOW ALL ASSEMBLY INSTRUCTIONS, SAFETY INFORMATION, AND OPERATING INSTRUCTIONS OF YOUR OWNER'S MANUAL BEFORE INITIAL START UP.



GRILL PARTS LIST

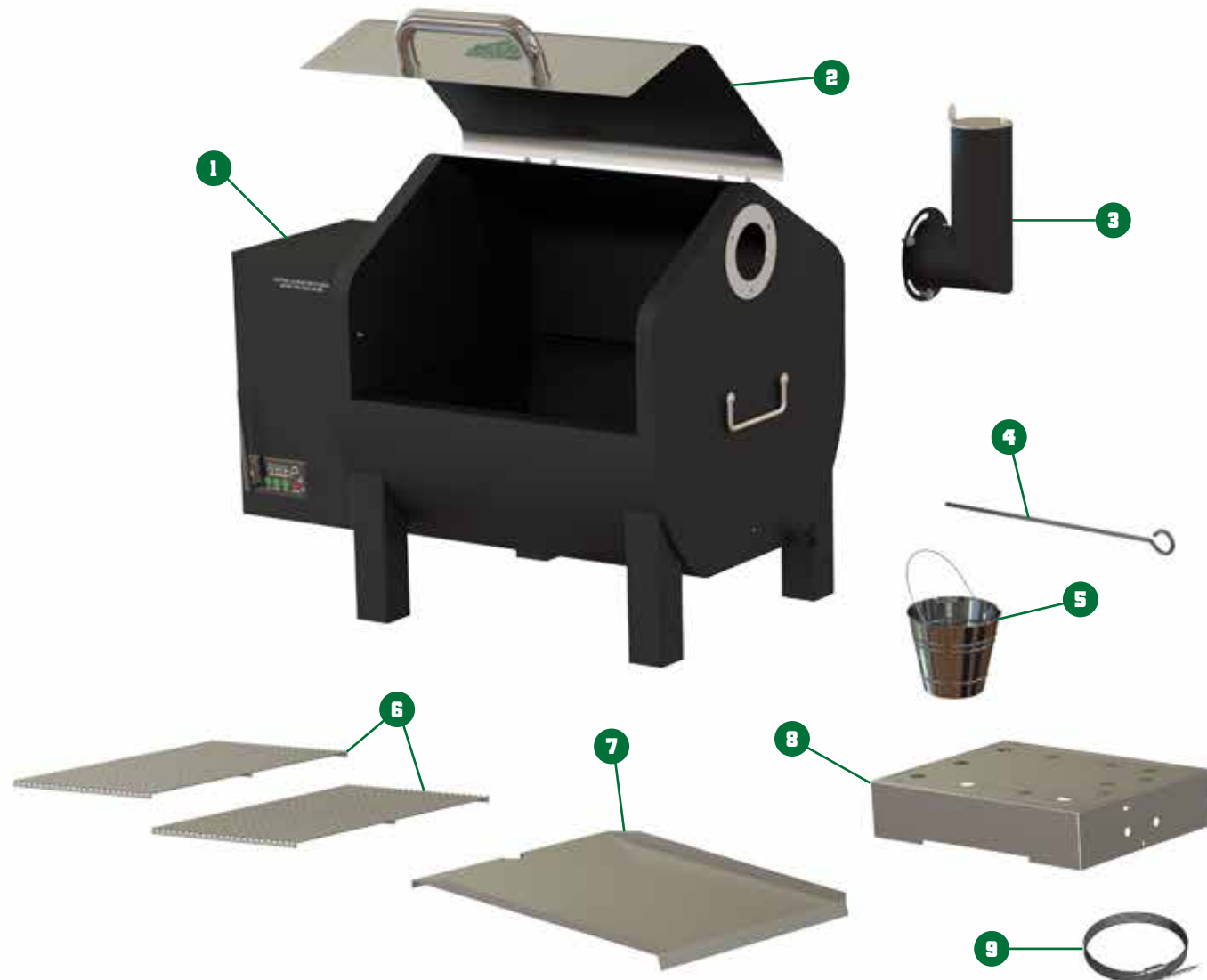

PART	DESCRIPTION
1	Grill Body
2	Lid
3	Chimney
4	Heat Shield Adjustment Handle
5	Drip Bucket
6	Grill Grates
7	Grease Tray
8	Heat Shield
9	Meat Probe



POWER COMPONENTS



HARDWARE

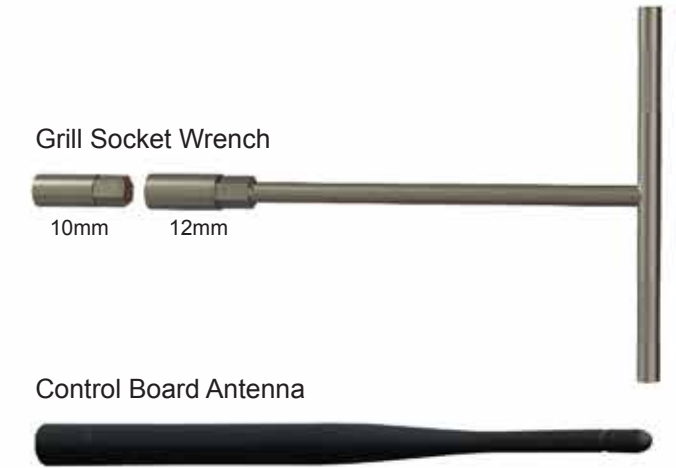

ASSEMBLY

PLEASE READ AND FOLLOW ALL INSTRUCTIONS CAREFULLY

UNBOXING

CAUTION! The grill is heavy. Be careful when lifting.

1 UNBOXING



Open and remove cardboard top.

2 UNBOXING



Open **STARTER BOX**. Reference parts list. Remove cardboard filling.

3 UNBOXING



Remove grill from box and internal parts from grill. Discard cardboard.

LID HANDLE

IMPORTANT! Keep 2 spacers on each side of the grill lid to minimize heat transfer to the handle.

HARDWARE

10mm 

4 REMOVE HANDLE



Unscrew handle from inside grill lid.

5 INSTALL HANDLE



Flip hand around to the front and fasten to lid as shown here.

CHIMNEY

IMPORTANT! Make sure the chimney cap ALWAYS stays open.

HARDWARE

10mm 

6 REMOVE BOLTS

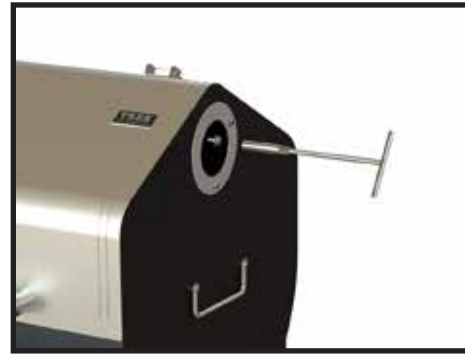

7 INSTALL CHIMNEY



HEAT SHIELD

IMPORTANT! For proper heat shield positioning, use the marks on the adjuster handle. The grill wall should align with the -.5 mark on the handle, setting the heat shield about 4 in. from the left inside grill wall.

HEAT SHIELD ADJUSTER

2 | 1 | 0 | 1 | 2
SWEET SPOT

8 HEAT SHIELD



Insert heat shield onto stainless steel slider mount brackets.

9 HEAT SHIELD ADJUSTER



Insert adjuster handle into hole on right side of grill wall and screw into the heat shield.

10 HEAT SHIELD POSITIONING

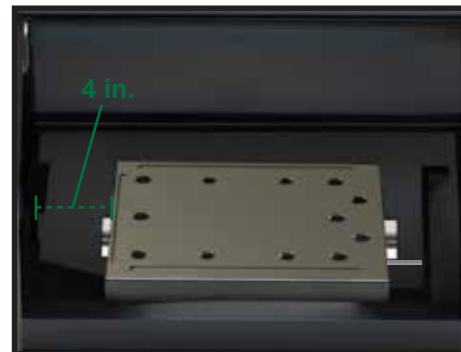

Recommended position for even heat distribution:
approx. 4 in. from left wall.

GREASE TRAY

IMPORTANT! Make sure to insert grease tray as shown below for proper temperature reading and grease drainage.

11 GREASE TRAY



Install grease tray with half-moon cut-out on left, near thermal sensor.

GRILL GRATES

12 GRILL GRATES



Insert grates as shown.

HOPPER GUARD

13 INSERT HOPPER GUARD

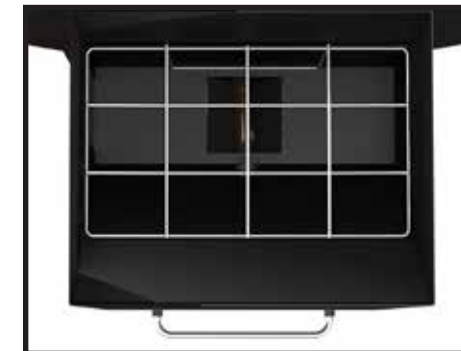

Open lid and install safety guard at base of hopper.

ANTENNA

14 INSTALL ANTENNA



Screw antenna onto control board.

GREASE BUCKET

15 INSTALL GREASE BUCKET



Hang bucket on drip spout.